

Specifications

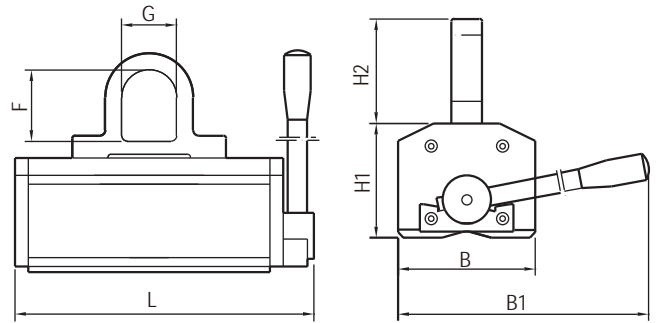

Features:

- > high power to weight ratio
- > compact and light
- > at least 3 safety factor
- > suitable for flat and round material
- > maintenance free design
- > safety device prevent accidental deactivation
- > can be switched off by one hand only

Model	Size	Safe Working Load	Width	Length	H1	H2	B1	F	G	Net Weight
PLM	100	100 kg/220 lb	70 (2.76)	130 (5.12)	60 (2.36)	53 (2.09)	176 (6.93)	35 (1.38)	28 (1.10)	3.5 kg/8 lb
PLM	300	300 kg/660 lb	95 (3.74)	205 (8.07)	83 (3.27)	70 (2.76)	220 (8.66)	47 (1.85)	40 (1.57)	10 kg/22 lb
PLM	600	600 kg/1320 lb	125 (4.92)	272 (10.71)	104 (4.09)	95 (3.74)	296 (11.65)	64 (2.52)	50 (1.97)	23 kg/51 lb
PLM	1000	1000 kg/2200 lb	160 (6.30)	318 (12.52)	140 (5.51)	95 (3.74)	410 (16.14)	64 (2.52)	50 (1.97)	44 kg/97 lb
PLM	2000	2000 kg/4400 lb	160 (6.30)	496 (19.53)	140 (5.51)	120 (4.72)	508 (20.00)	80 (3.15)	60 (2.36)	72 kg/158 lb
PLM	3000	3000 kg/6600 lb	230 (9.06)	510 (20.08)	212 (8.35)	155 (6.10)	600 (23.62)	100 (3.94)	70 (2.76)	160 kg/352 lb
PLM	5000	5000 kg/11000 lb	360 (14.17)	725 (28.54)	261 (10.28)	180 (7.09)	980 (38.58)	100 (3.94)	70 (2.76)	450 kg/990 lb

Model	Size	Load Plate Max	Plate Min Thickness	Plate Max Length	Load Round Max	Round Min Thickness	Round Max Diameter
PLM	100	100 kg/220 lb	15 (0.59)	1000 (39.37)	40 kg/88 lb	8 (0.31)	150 (5.9)
PLM	300	300 kg/660 lb	20 (0.79)	1500 (59.06)	120 kg/264 lb	12 (0.47)	180 (7.09)
PLM	600	600 kg/1320 lb	25 (0.98)	2000 (78.74)	240 kg/528 lb	20 (0.79)	250 (9.84)
PLM	1000	1000 kg/2200 lb	40 (1.57)	3000 (118.11)	400 kg/880 lb	25 (0.98)	280 (11.02)
PLM	2000	2000 kg/4400 lb	55 (2.17)	3000 (118.11)	800 kg/1760 lb	35 (1.38)	350 (13.78)
PLM	3000	3000 kg/6600 lb	70 (2.76)	3500 (137.8)	1200 kg/2640 lb	45 (1.77)	400 (15.75)
PLM	5000	5000 kg/11000 lb	85 (3.35)	4000 (157.48)	2000 kg/4400 lb	55 (2.17)	450 (17.7)

Functional parameters



PLM100

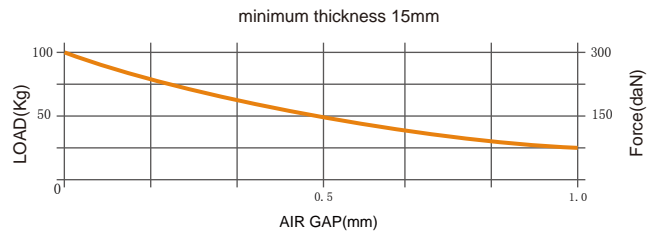

PLM300

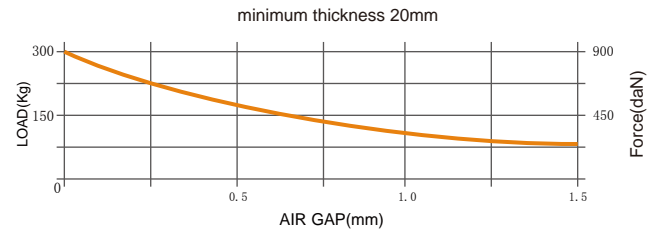

PLM600

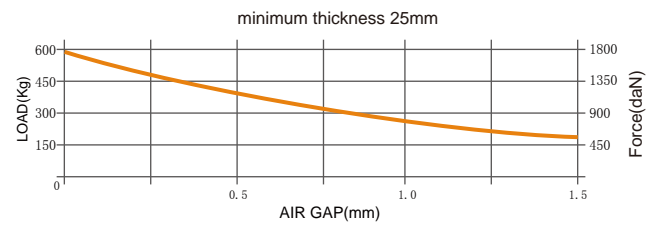

PLM1000

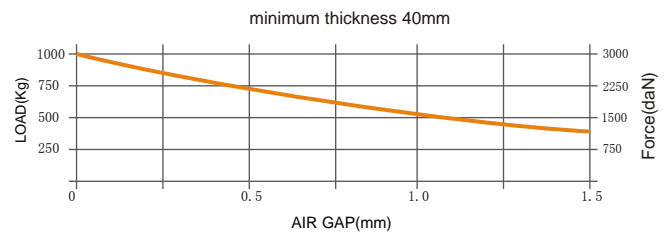

PLM2000

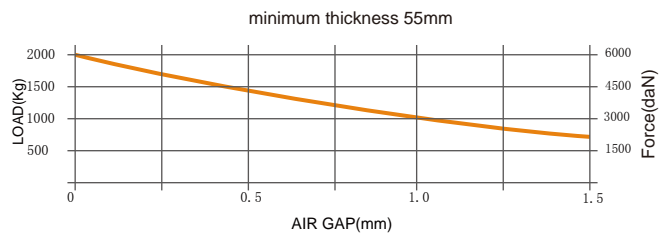

PLM3000

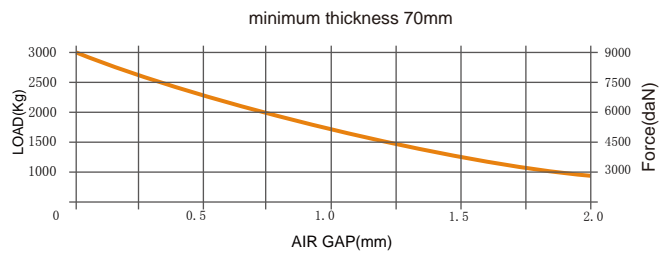

PLM5000

